

SCALE: 1" = 1'-0"

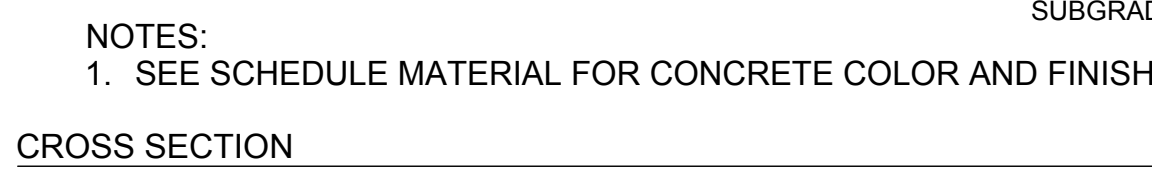

SCALE: 1" = 1'-0"

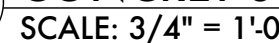
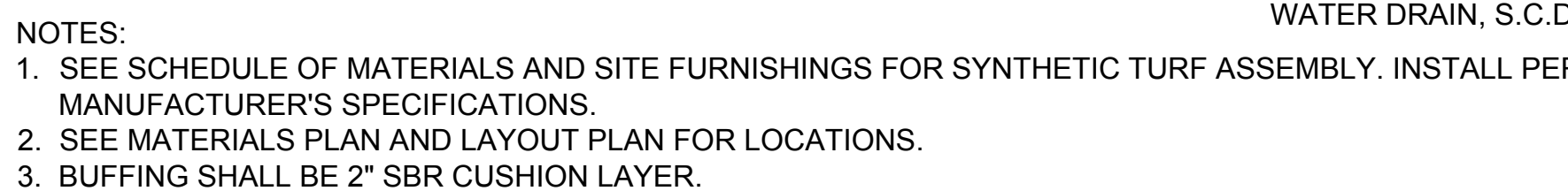
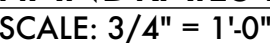
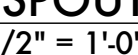

SCALE: 1" = 1'-0"

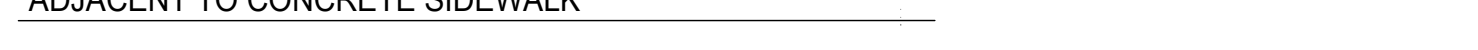
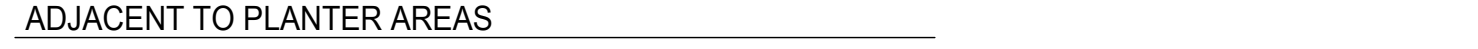

NOTES:

1. INSTALL PAVERS AND EDGING PER MANUFACTURER'S SPECIFICATION. INSTALL SPACERS TO PROVIDE $\frac{3}{16}$ " GAP BETWEEN THE PAVERS.
2. SEE SCHEDULE OF MATERIALS AND FURNISHINGS FOR UNIT PAVERS AND METAL EDGE RESTRAINT

SCALE: 1" = 1'-0"

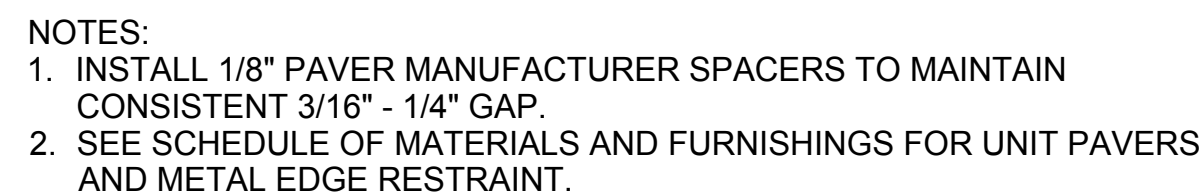

SCALE: 1" = 1'0"

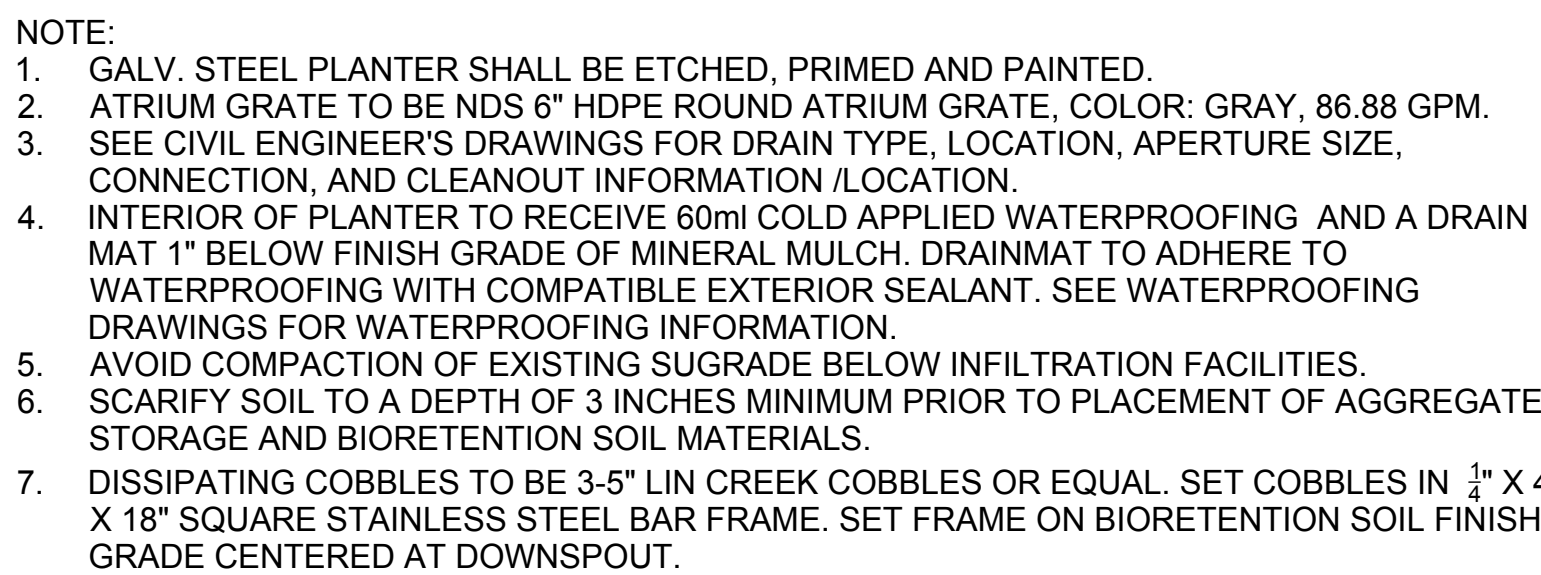

SCALE: 1" = 1' 0"

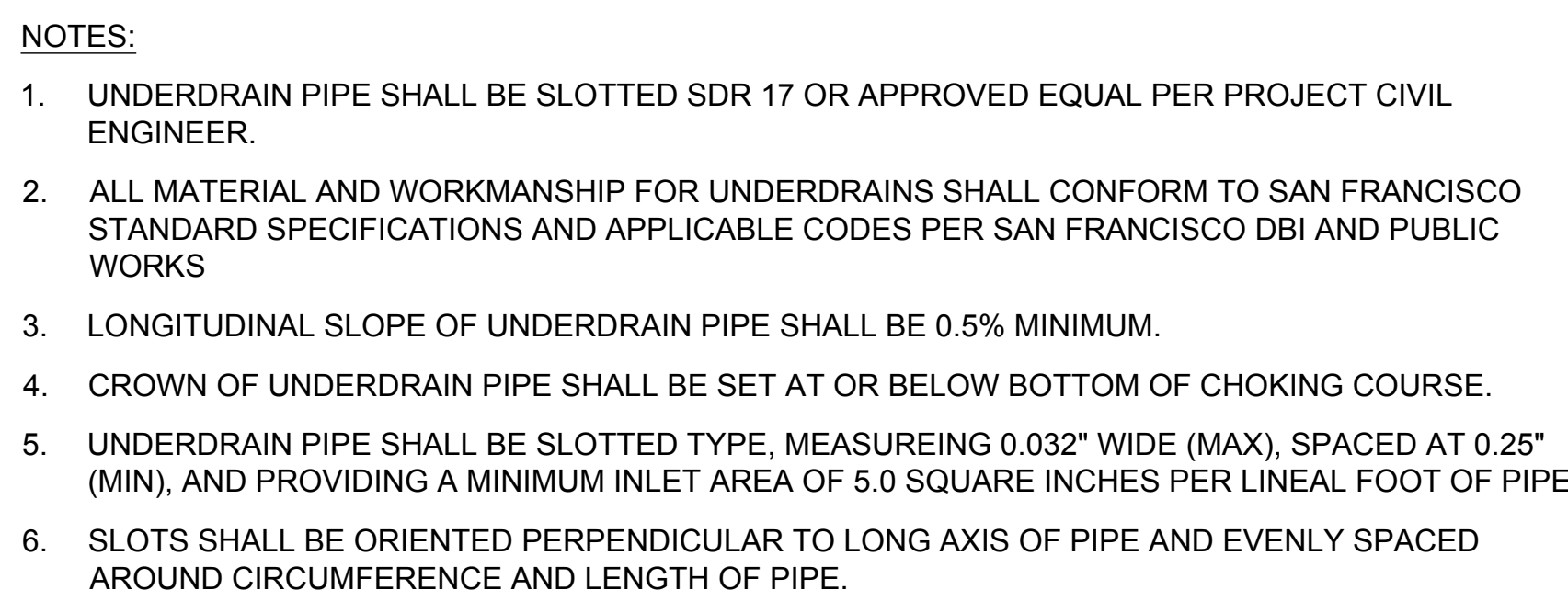

SCALE: 3" = 1'-0"

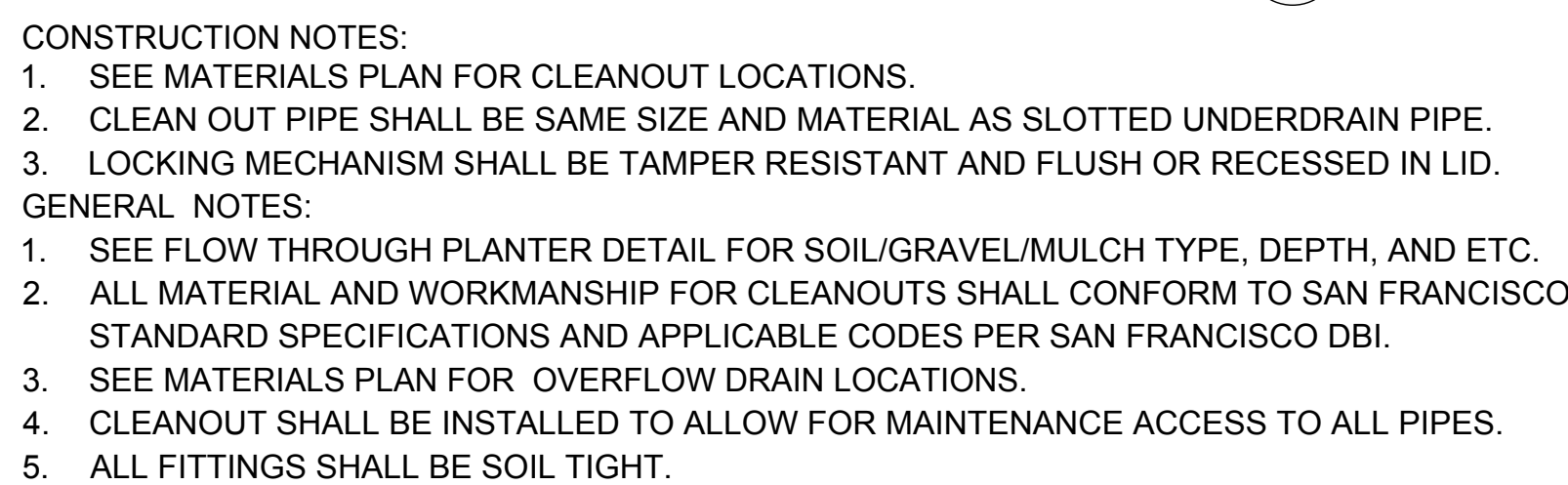

SCALE: 3/4" = 1' 0"



SCALE: 1/2" = 1'-0"



SCALE: 1" = 1' 0"

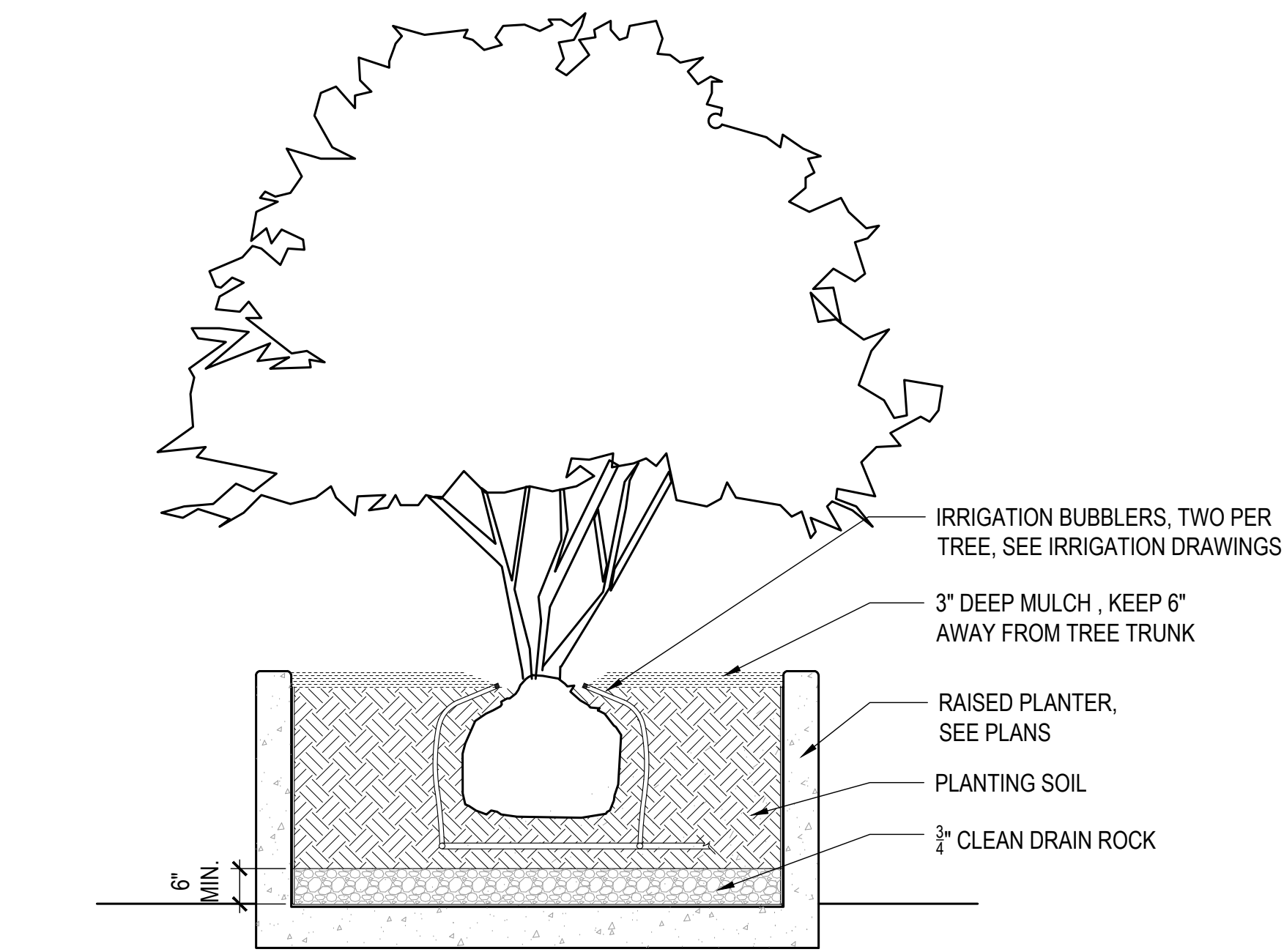

5 TREE IN RAISED PLANTER
SCALE: 1/2" = 1'-0"

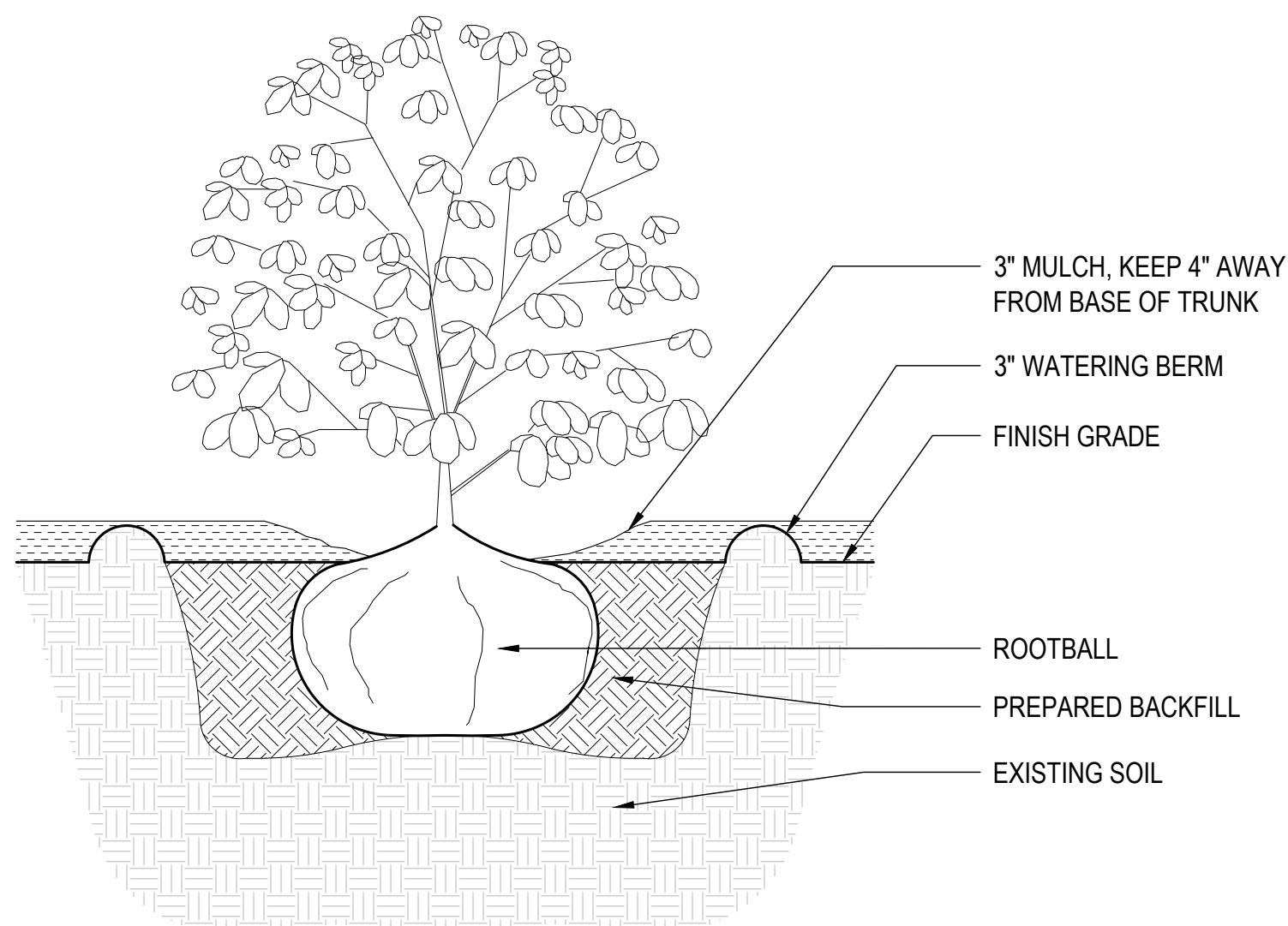

6 SHRUB PLANTING
SCALE: 1"= 1'-0"

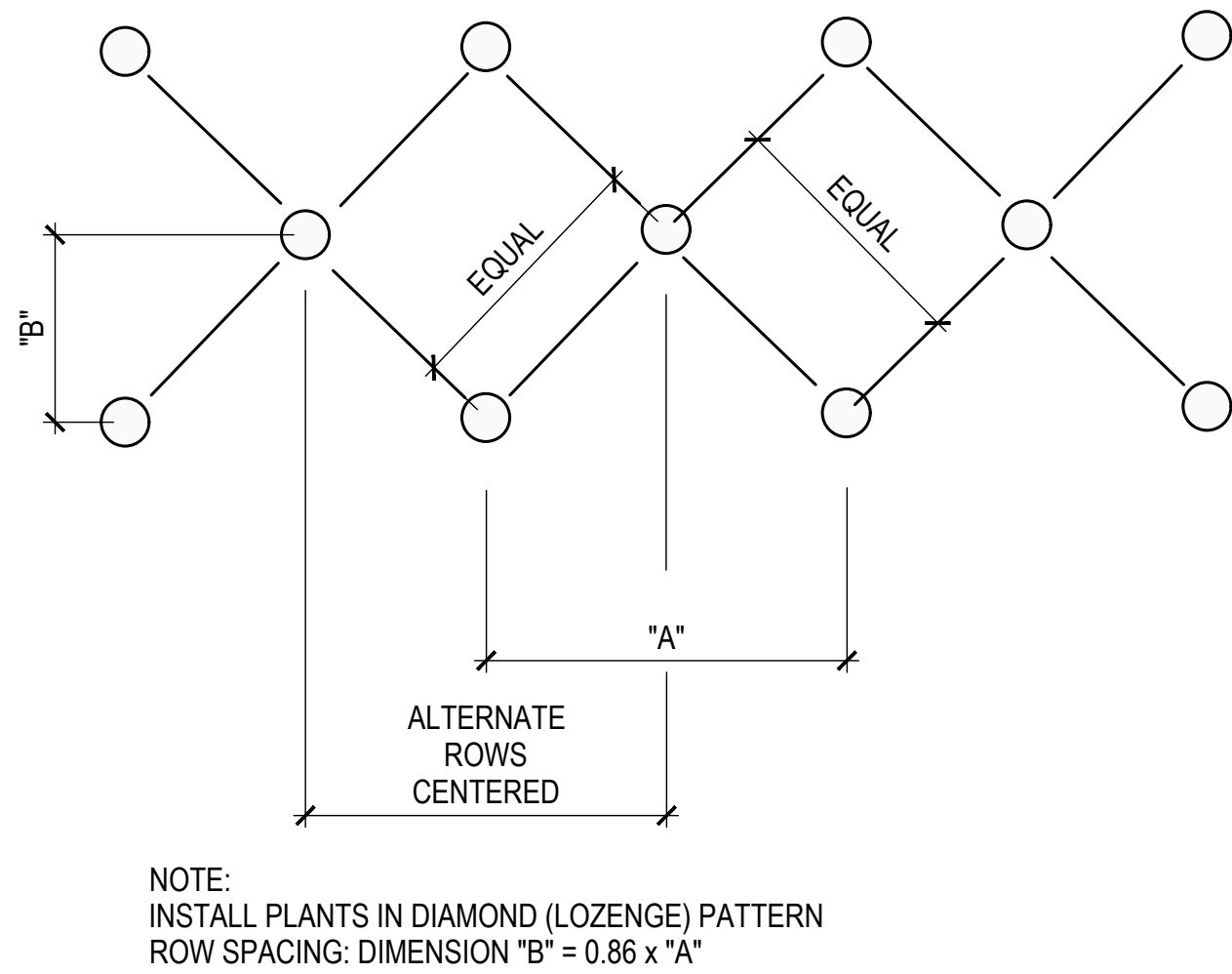

7 PLANTING SPACING
SCALE: N.T.S.

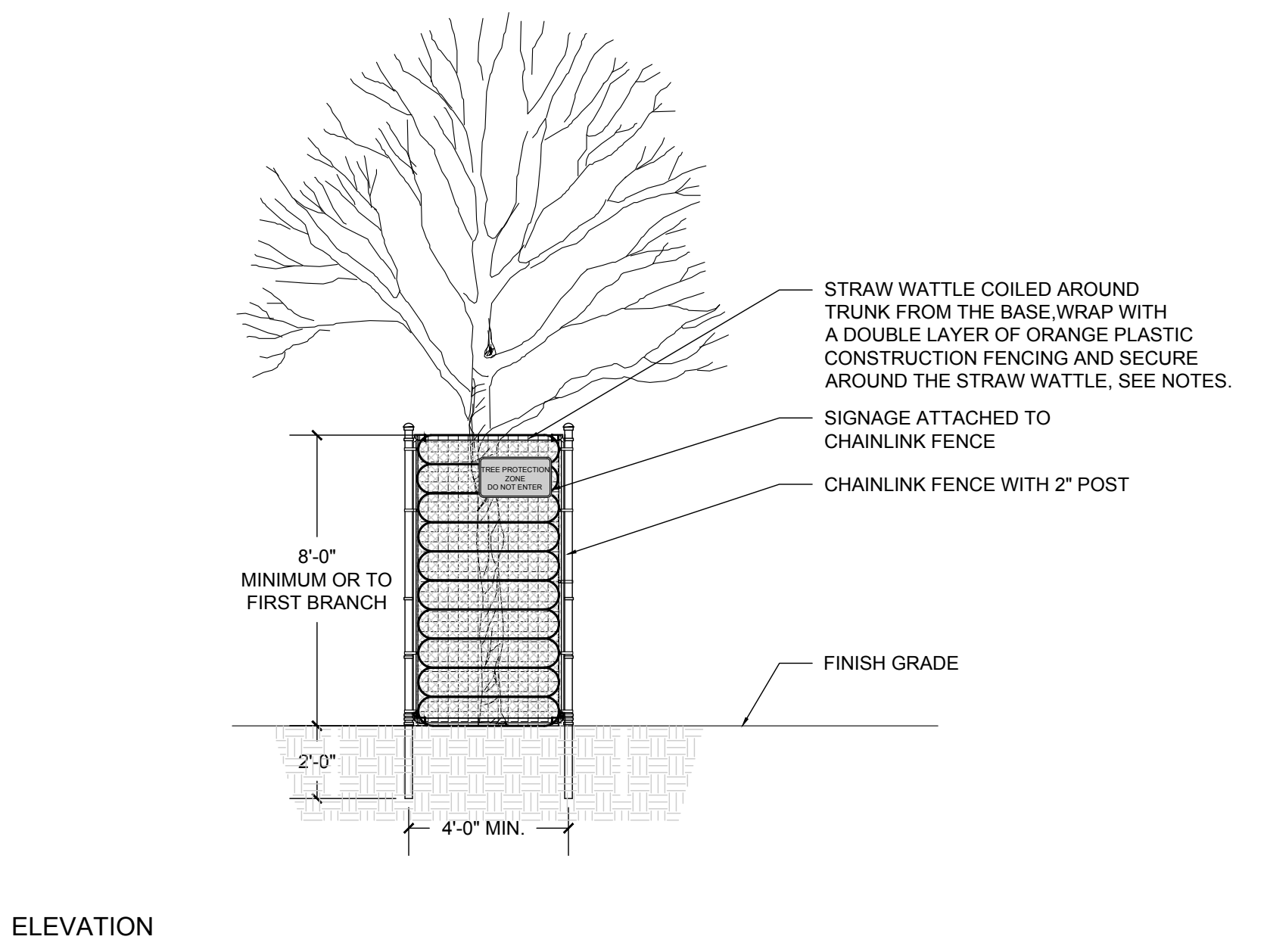
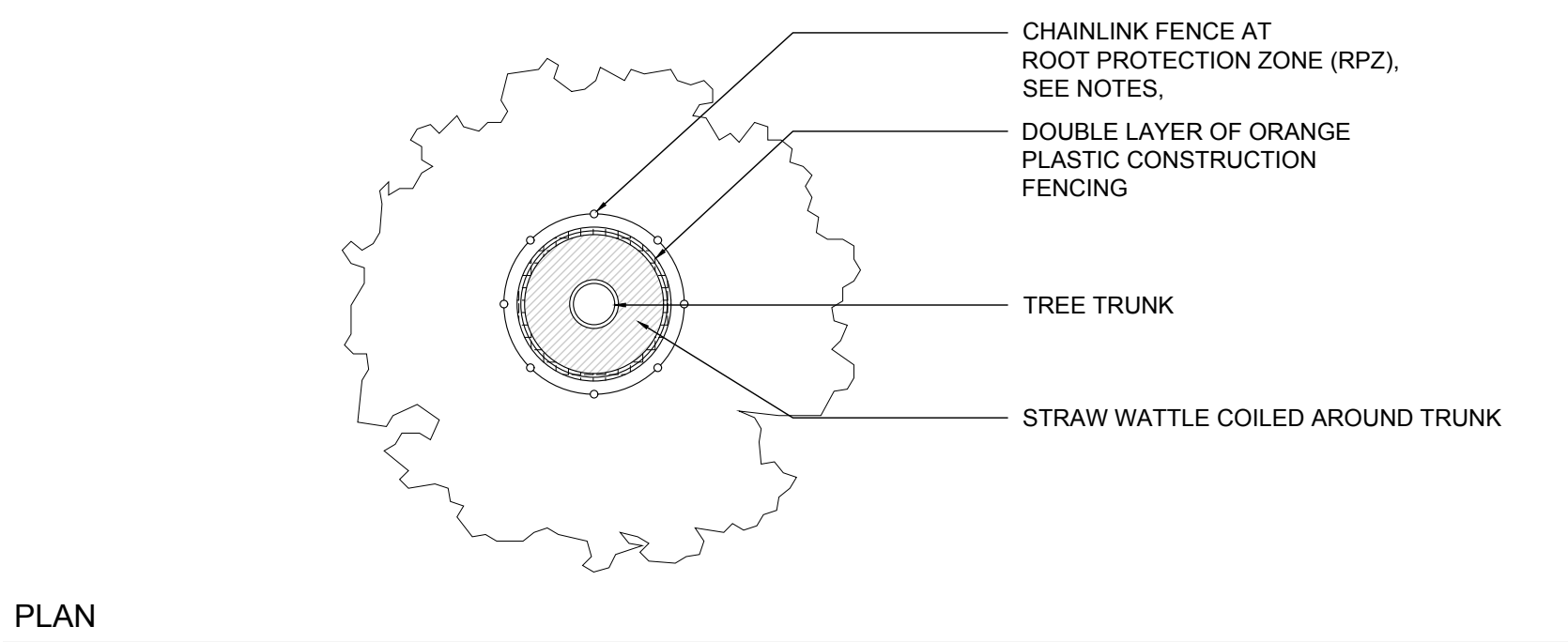

2 STREET TREE PROTECTION
SCALE: 1/2" = 1'-0"

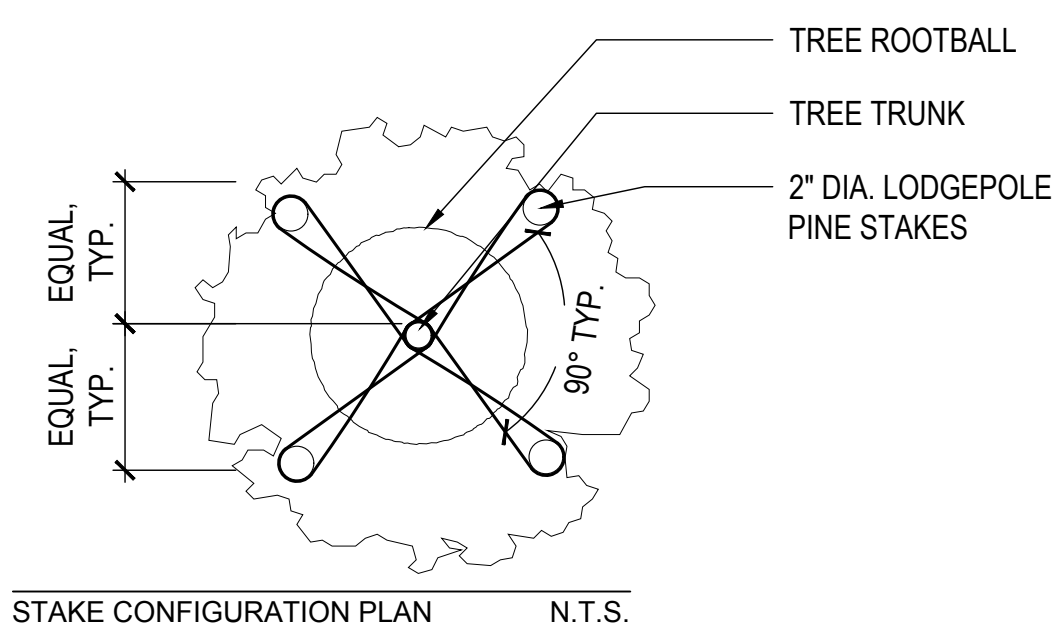

STAKE CONFIGURATION PLAN N.T.S.

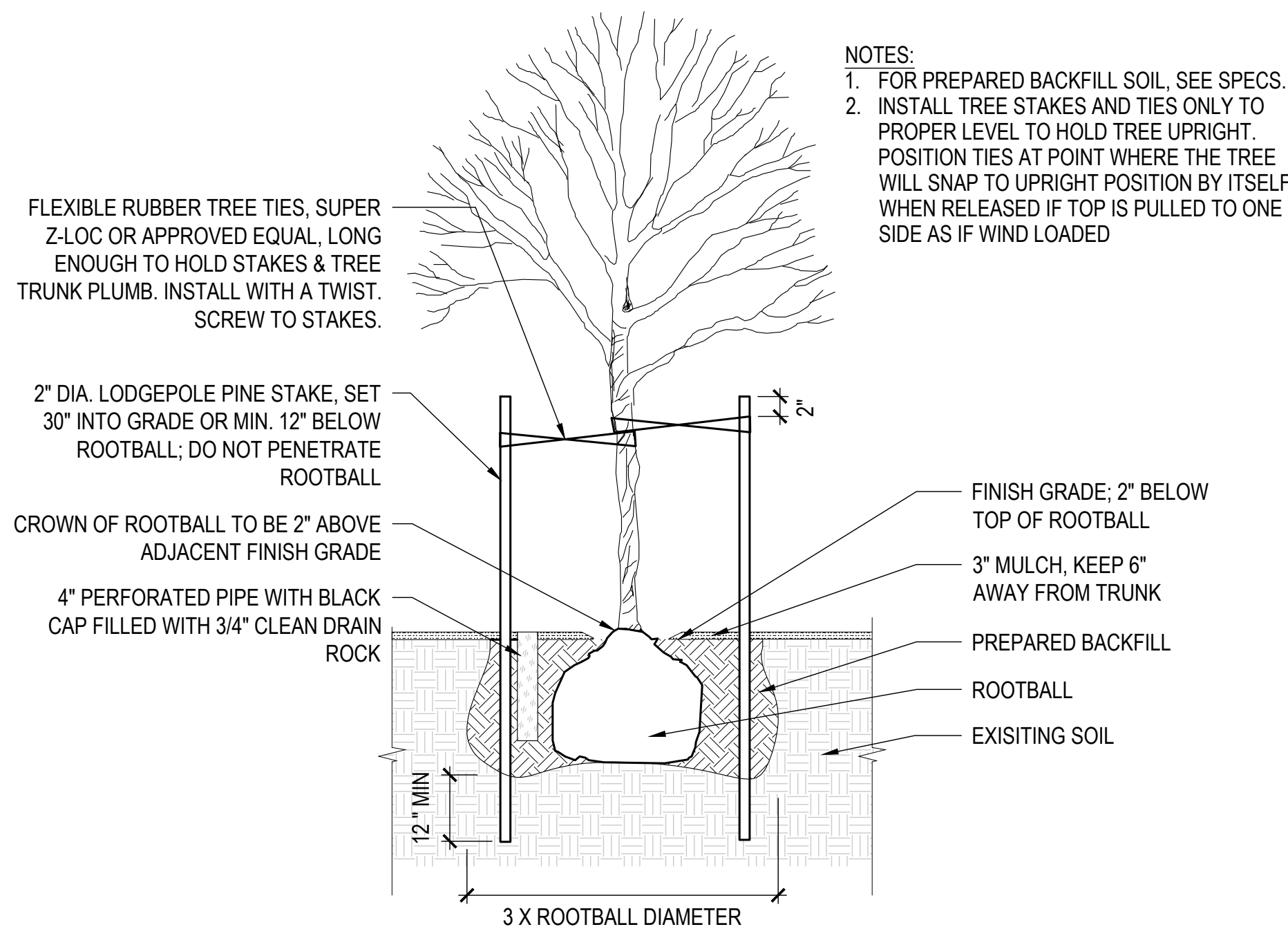

4 TREE PLANTING
SCALE: 1/2" = 1'-0"

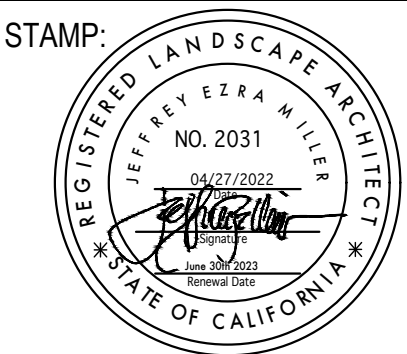

REVISION SCHEDULE	
NO.	ISSUE
1	SITE PERMIT
2	04/27/2022

JOB NUMBER:	1941
DRAWN BY:	MNJZ
CHECKED BY:	JM
ISSUE DATE:	04/27/2022

SCALE:
TITLE:
PLANTING DETAILS

SHEET:

L6.00



TNDC
201 Eddy Street
San Francisco, CA
94102

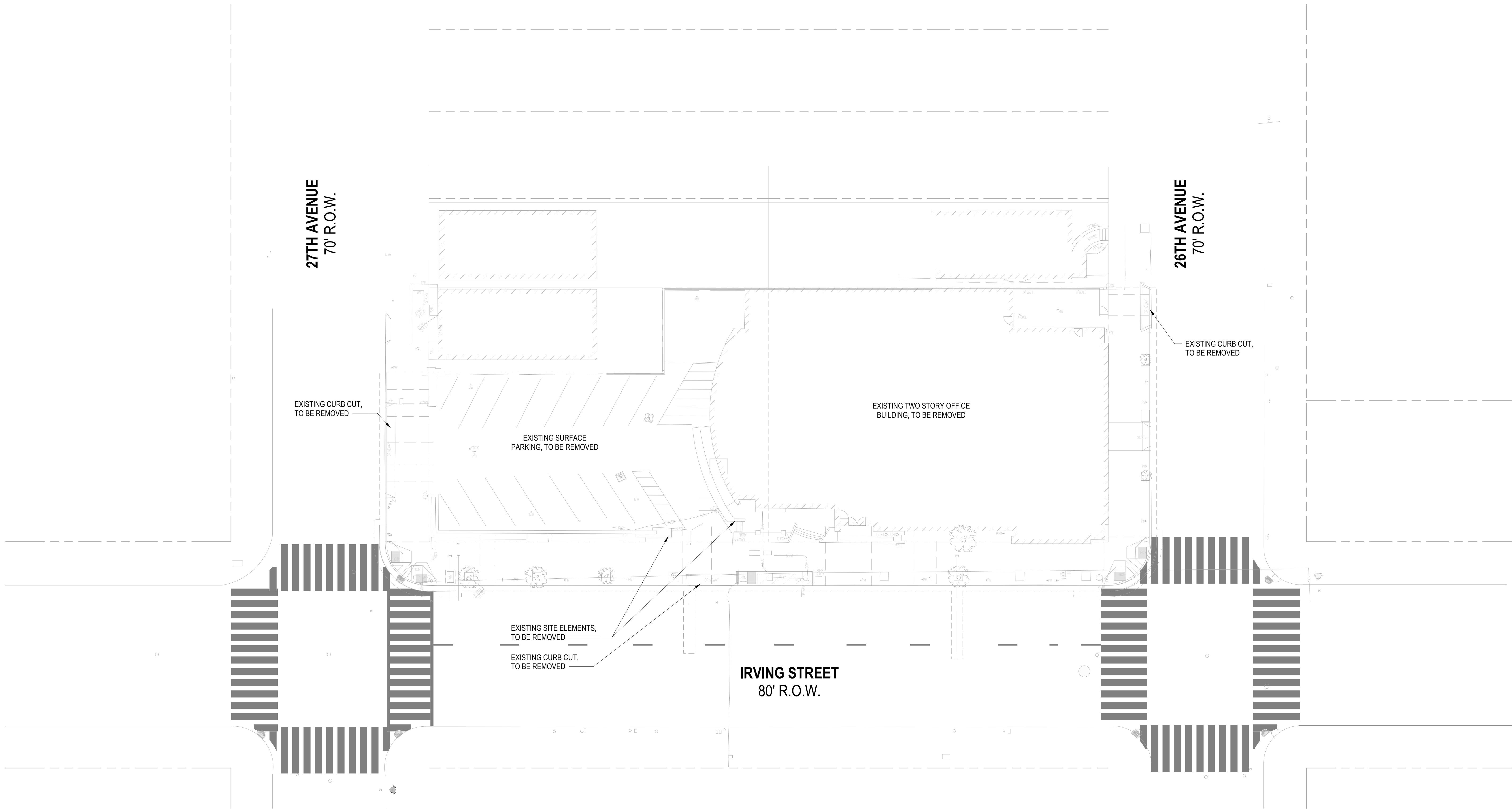

EXISTING SITE PLAN 1
1/16" = 1'-0"

2550 IRVING ST
2550 Irving Street
San Francisco, CA 94122

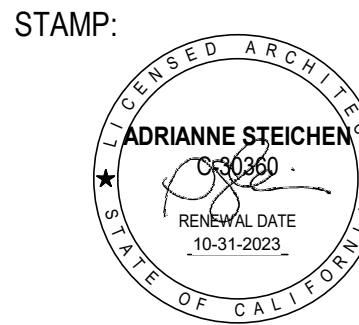

REVISION SCHEDULE	
NO. ISSUE	DATE
SITE PERMIT	OCT02021

JOB NUMBER: 1941
DRAWN BY: CA - JB
CHECKED BY: AS, SP, KSS
ISSUE DATE: 04/27/2022
SCALE: 1/16" = 1'-0"
TITLE: SITE PLAN - EXISTING

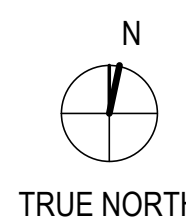

SHEET:
A1.00

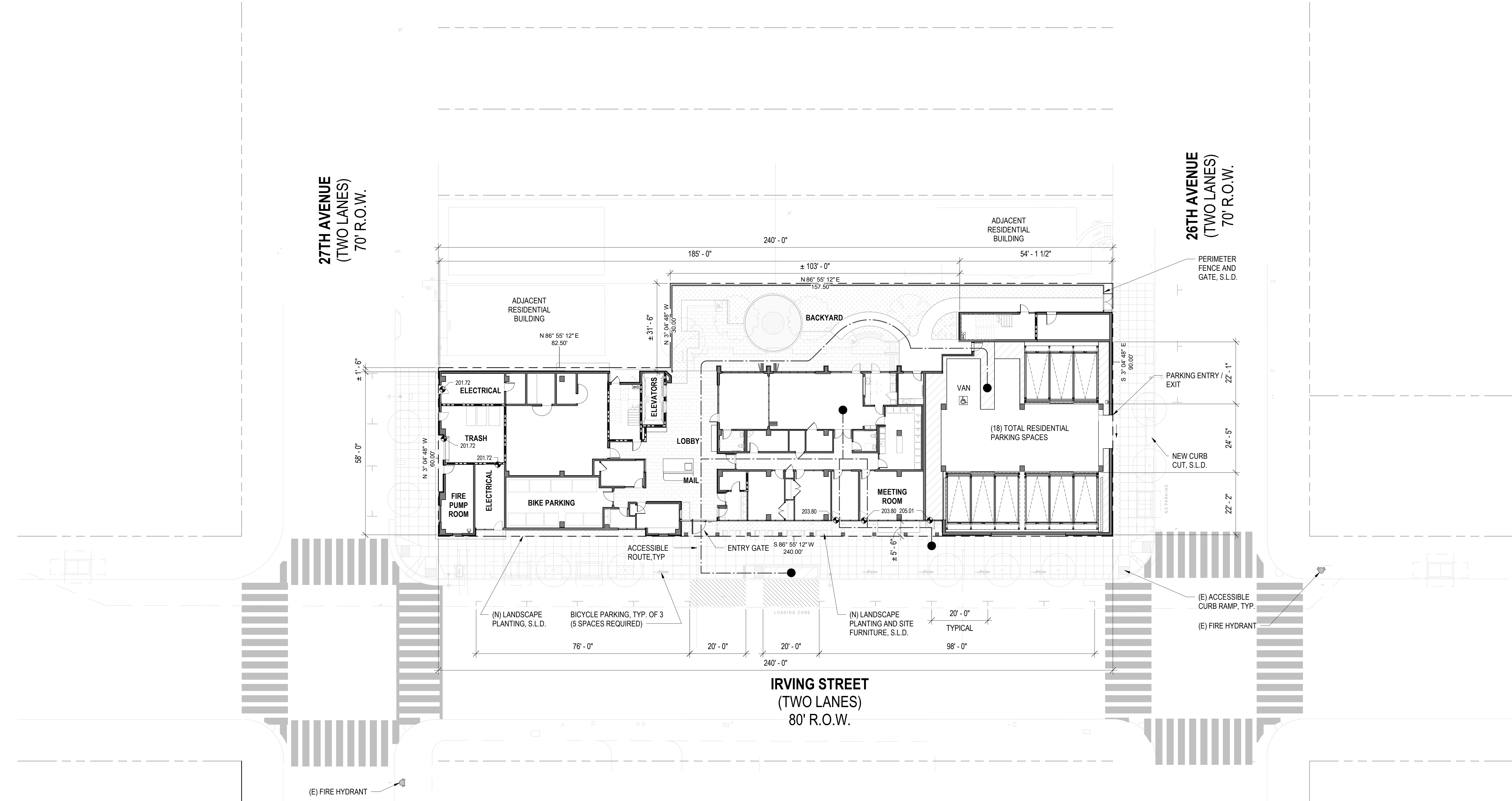

SITE PLAN NOTES	
1	PROVIDE BARRIER-FREE ACCESSIBLE ROUTE OF TRAVEL FOR SITE ACCESSIBILITY PER THE BARRIER FREE NOTES AND CBC CHAPTER 11A AND/OR CHAPTER 11B.
2	SITE LIGHTING TO BE ON-BUILDING OR ON POLES, BAFFLED AND DIRECTED DOWNWARD TO PROTECT AGAINST OFF-SITE LIGHTING IMPACTS. LIGHTING LEVELS AND ILLUMINATION SHALL BE DESIGNED TO REDUCE GLARE.
3	CURB RAMPS SHALL NOT EXCEED A SLOPE OF 1:12 (8.33%).
4	ENTRANCE RAMPS TO BUILDINGS SHALL NOT EXCEED A SLOPE OF 1:20 (5%) UNLESS RAILINGS ARE SHOWN ON THE ARCHITECTURAL SITE PLAN. IN WHICH CASE, THE SLOPE SHALL NOT EXCEED 1:12 (8.33%).
5	A MAXIMUM 2% SLOPE LANDING SHALL BE PROVIDED AT PEDESTRIAN ENTRANCES TO BUILDINGS.
6	THE MAXIMUM CROSS SLOPE AT ANY RAMP OR SIDEWALK SHALL NOT EXCEED 2%. THE MAXIMUM SLOPE WITHIN PARKING STALLS SHALL BE 2% IN ANY DIRECTION.
7	ALL ELEVATIONS ARE BASED ON SEA LEVEL, U.O.N.

1611 TELEGRAPH AVE.
SUITE 200
OAKLAND, CA 94612
T: 510.465.7010 | F: 510.465.8575
www.pyatok.com

TNDc
HOME. HEALTHY. VOICE.

TNDc

201 Eddy Street
San Francisco, CA
94102

2550 IRVING ST
2550 Irving Street
San Francisco, CA 94122

STAMP:

REVISION SCHEDULE

NO.	ISSUE	DATE
1	SITE PERMIT	OCT02021

CONCEPTUAL SITE PLAN 1
1/16" = 1'-0"

N

TRUE NORTH

0' 4' 8' 16' 32'

JOB NUMBER: 1941
DRAWN BY: CA - JB
CHECKED BY: AS, SP, KSS
ISSUE DATE: 04/27/2022
SCALE: 1/16" = 1'-0"
TITLE: SITE PLAN - PROPOSED
SHEET: A1.10

© 2021 PYATOK ARCHITECTURE & URBAN DESIGN

5/2/2022 8:20:59 AM

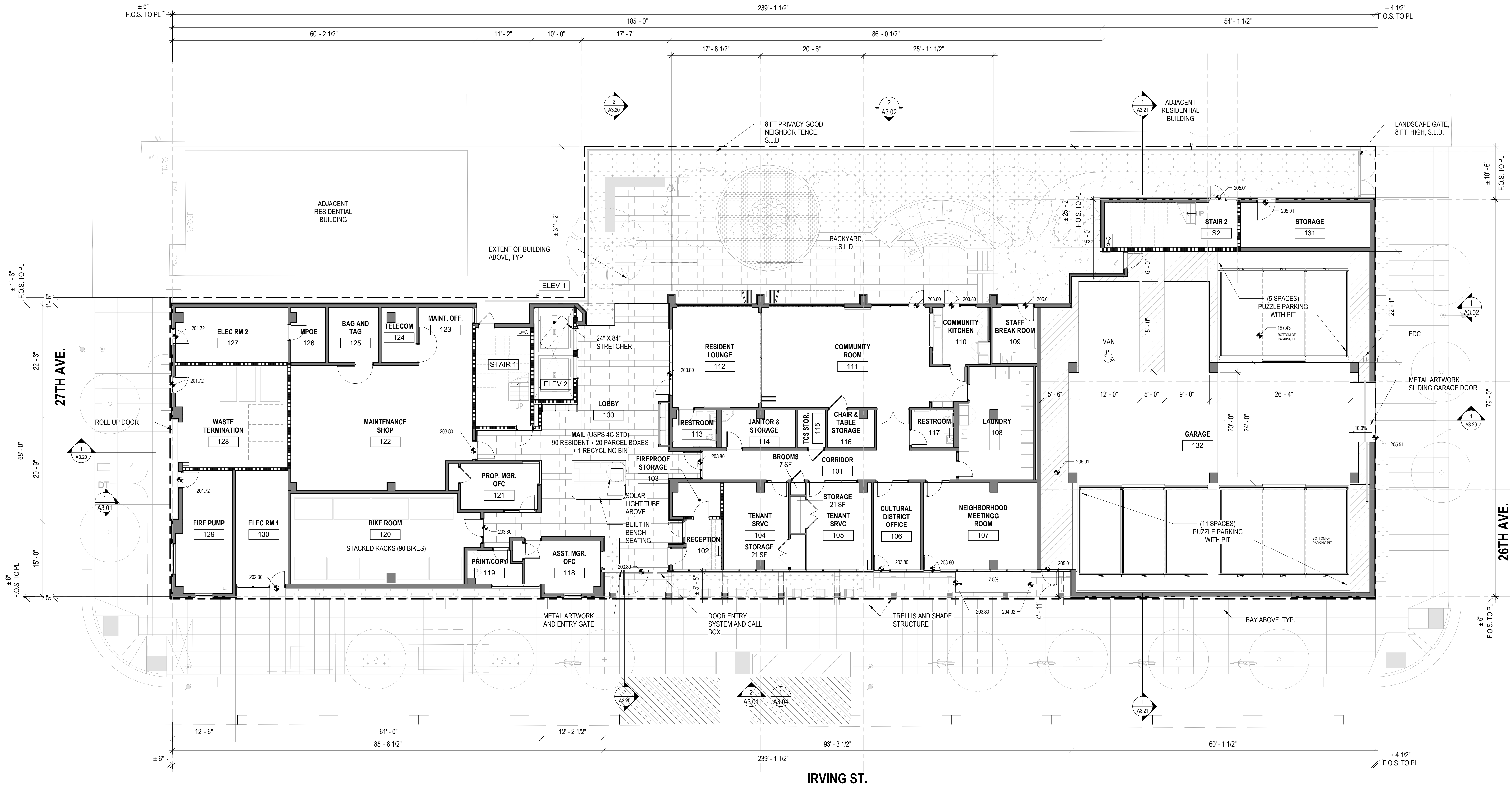

IRVING ST.

OVERALL FLOOR PLAN - LEVEL 1
1/8" = 1'-0"

FLOOR PLAN GENERAL NOTES

- 1 SEE SHEET G0.00 FOR SYMBOLS & ABBREVIATIONS
- 2 THESE PLANS SHOW UNIQUE INFORMATION ONLY. SEE ENLARGED PLANS FOR INFORMATION NOT SHOWN.
- 3 REFERENCE ACCESSIBILITY CODE SHEETS G9.XX FOR ALL ACCESSIBILITY STANDARDS, REQUIREMENTS AND DIAGRAM.
- 4 SEE CIVIL PLANS FOR THE BUILDING LOCATION ON SITE AND PRECISE GRADING PLANS.
- 5 FOR PARKING TABULATION REFER TO SHEET G0.00
- 6 ALL DIMENSIONS ARE TO FACE OF MASONRY, CONCRETE, STUD, OR CENTERLINE OF COLUMN OR DEMISING WALL (C.L.). U.O.N. ALL "CLEAR" DIMENSIONS ARE TO FACE OF FINISH.
- 7 ALL CONSTRUCTION TO BE FIRE-RATED PER THE PROJECT DATA ON THE G0.XX SHEETS AND ASSEMBLIES, SHEETS A9.X. UNIT DEMISING WALLS ARE 1-HR RATED, TYPICAL. FOR DETAILED LOCATION OF WALL ASSEMBLY TYPES, SEE ENLARGED PLANS.
- 8 ALL STAIR, ELEVATOR, TRASH CHUTE, AND VENTILATION SHAFTS TO BE 2-HR FIRE RATED BARRIERS IF CONNECTING MORE THAN 3 STORIES. IF LESS THAN 3 STORIES, THESE MUST BE 1-HR FIRE-RATED CONSTRUCTION.
- 9 WHERE PROVIDED, CMU PARTITION WALLS TO RECEIVE REINFORCING PER STRUCTURAL DRAWINGS AND TERMINATE AT STRUCTURE ABOVE, U.O.N.
- 10 ALL INTERIOR EXPOSED CONCRETE WITHIN PUBLIC SPACES IS ARCHITECTURAL FINISH, U.O.N.
- 11 STUD SIZES TYPICALLY USED THROUGHOUT PROJECT ARE SHOWN - REFER TO STUD SIZE ON WALL ASSEMBLIES, SHEET A9.X, FOR REQUIRED SIZES, GAUGES AND SPACING REQUIRED. COORDINATE BLOCKING AND BRACING REQUIREMENTS FOR ALL WALL-HUNG ITEMS AND VERIFY LOCATIONS PRIOR TO INSTALLATION OF FINISHES.
- 12 THIS BUILDING TO BE FIRE SPRINKLERED PER APPLICABLE SECTIONS OF CBC CHAPTER 9 AND NFPA 13.
- 13 CLASS 1 STANDPIPES TO BE INTERCONNECTED.
- 14 PROVIDE ALL NECESSARY WALL ACCESS PANELS AS REQUIRED FOR MECHANICAL, PLUMBING, FIRE SPRINKLER AND ELECTRICAL SYSTEMS. IN FIRE RATED ASSEMBLIES PROVIDE RATED ACCESS PANELS WITH SELF CLOSING DEVICES.
- 15 SEE INDIVIDUAL UNIT FLOOR PLANS OR ENLARGED BUILDING PLANS FOR DETAILED INFORMATION ON DIMENSIONS, CONSTRUCTION, DOORS, WINDOWS, AND OTHER ELEMENTS, TYPICAL.
- 16 INTERIOR FINISHES SHALL COMPLY WITH CBC 803.1 FLAME SPREAD PROVISION, SEE INTERIOR DRAWINGS.
- 17 FOR DOOR & WINDOW SCHEDULES SEE SHEET A9.X & A9.X.
- 18 RAMP SLOPES ARE MEASURED FROM CENTERLINE OF RAMP.
- 19 ALL EXIT STAIRS TO COMPLY WITH CBC CHAPTERS 10, 11A AND/OR 11B. EXIT STAIRS AND LANDINGS TO BE 44 INCHES MINIMUM IN WIDTH. STAIR RISERS TO BE MAXIMUM 7 INCHES HIGH, AND TREADS TO BE 11 INCHES MINIMUM DEEP.
- 20 SEE ROOF PLAN GENERAL NOTES FOR DRAINAGE, VENTILATION, AND ROOF ACCESS NOTES.
- 21 ALL RESIDENTIAL UNITS THAT FACE ROADS ARE EQUIPPED WITH EITHER MECHANICAL VENTILATION OR PASSIVE FRESH-AIR INLETS, SEE MECHANICAL DRAWINGS FOR MORE INFORMATION.
- 22 SEE SIGNAGE PLANS AND DETAILS ON A10.X FOR ADDITIONAL INFORMATION REGARDING SIGNS AT UNIT ENTRIES, ELEVATORS, STAIRS, EGRESS COMPONENTS, COMMON AREA DOORS.

FLOOR PLAN LEGEND

2 HR RATED WALL CONSTRUCTION

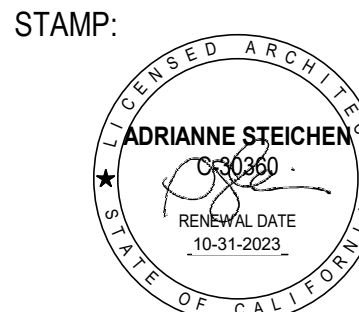
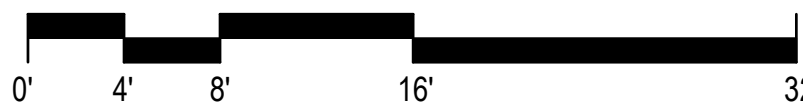
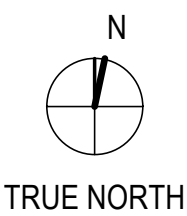

REVISION SCHEDULE	
NO.	ISSUE
1	SITE PERMIT
2	04/27/2021

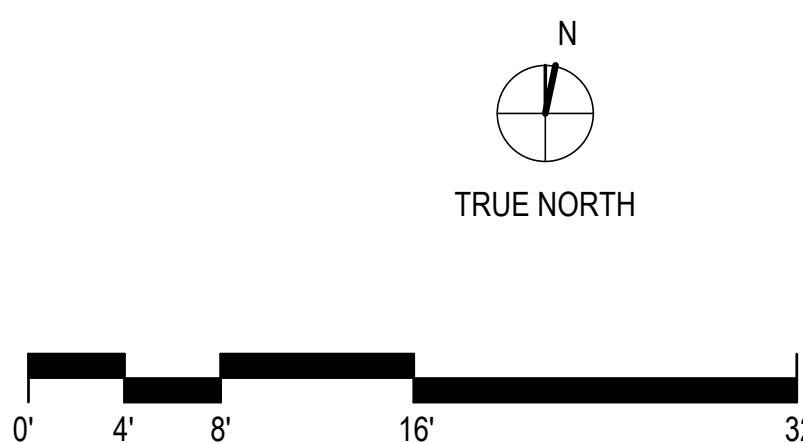
 2 HR RATED WALL CONSTRUCTION



FLOOR PLAN - LEVEL 3 ①
1/8" = 1'-0"

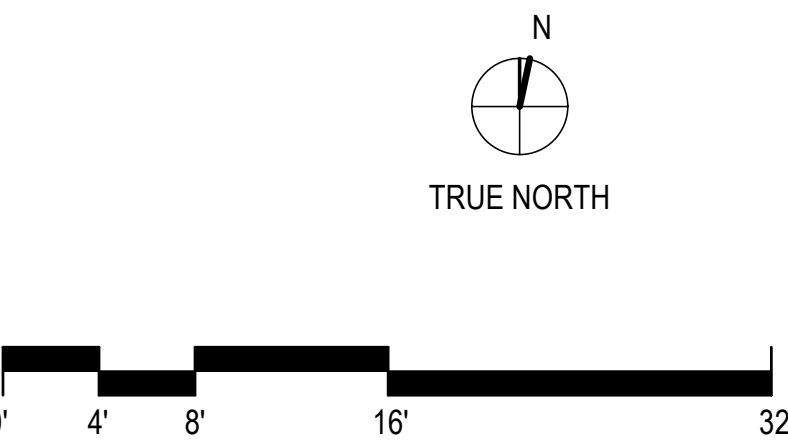

UNIT MATRIX LEVEL 3		
Unit Type	Unit Accessibility	Count
STUDIO: 1	ADAPTABLE	1
1 BEDROOM	ADAPTABLE	4
1 BEDROOM	ADAPTABLE, COMMUNICATIONS	1
1 BEDROOM	MOBILITY ACCESSIBLE	1
1 BEDROOM: 6		
2 BEDROOM	ADAPTABLE	3
2 BEDROOM	MOBILITY ACCESSIBLE	1
2 BEDROOM: 4		
3 BEDROOM	ADAPTABLE	2
3 BEDROOM	ADAPTABLE, COMMUNICATIONS	1
3 BEDROOM	MOBILITY ACCESSIBLE	1
3 BEDROOM: 4		
UNIT TOTAL: 15		

FLOOR PLAN GENERAL NOTES

- 1 SEE SHEET G0.00 FOR SYMBOLS & ABBREVIATIONS
- 2 THESE PLANS SHOW UNIQUE INFORMATION ONLY. SEE ENLARGED PLANS FOR INFORMATION NOT SHOWN.
- 3 REFERENCE ACCESSIBILITY CODE SHEETS G9.XX FOR ALL ACCESSIBILITY STANDARDS, REQUIREMENTS AND DIAGRAM.
- 4 SEE CIVIL PLANS FOR THE BUILDING LOCATION ON SITE AND PRECISE GRADING PLANS.
- 5 FOR PARKING TABULATION REFER TO SHEET G0.00
- 6 ALL DIMENSIONS ARE TO FACE OF MASONRY, CONCRETE, STUO, OR CENTERLINE OF COLUMN OR DEMISING WALL (C.L.). U.O.N. ALL "CLEAR" DIMENSIONS ARE TO FACE OF FINISH.
- 7 ALL CONSTRUCTION TO BE FIRE-RATED PER THE PROJECT DATA ON THE G0.XX SHEETS AND ASSEMBLIES, SHEETS A9.X. UNIT DEMISING WALLS ARE 1-HR RATED, TYPICAL. FOR DETAILED LOCATION OF WALL ASSEMBLY TYPES, SEE ENLARGED PLANS.
- 8 ALL STAIR, ELEVATOR, TRASH CHUTE, AND VENTILATION SHAFTS TO BE 2-HR FIRE RATED BARRIERS IF CONNECTING MORE THAN 3 STORIES. IF LESS THAN 3 STORIES, THESE MUST BE 1-HR FIRE-RATED CONSTRUCTION.
- 9 WHERE PROVIDED, CMU PARTITION WALLS TO RECEIVE REINFORCING PER STRUCTURAL DRAWINGS AND TERMINATE AT STRUCTURE ABOVE, U.O.N.
- 10 ALL INTERIOR EXPOSED CONCRETE WITHIN PUBLIC SPACES IS ARCHITECTURAL FINISH, U.O.N.
- 11 STUD SIZES TYPICALLY USED THROUGHOUT PROJECT ARE SHOWN - REFER TO STUD SIZE ON WALL ASSEMBLIES, SHEET A9.X, FOR REQUIRED SIZES, GAUGES AND SPACING REQUIRED. COORDINATE BLOCKING AND BRACING REQUIREMENTS FOR ALL WALL-HUNG ITEMS AND VERIFY LOCATIONS PRIOR TO INSTALLATION OF FINISHES.
- 12 THIS BUILDING TO BE FIRE SPRINKLERED PER APPLICABLE SECTIONS OF CBC CHAPTER 9 AND NFPA 13.
- 13 CLASS 1 STANDPIPES TO BE INTERCONNECTED.
- 14 PROVIDE ALL NECESSARY WALL ACCESS PANELS AS REQUIRED FOR MECHANICAL, PLUMBING, FIRE SPRINKLER AND ELECTRICAL SYSTEMS. IN FIRE RATED ASSEMBLIES PROVIDE RATED ACCESS PANELS WITH SELF CLOSING DEVICES.
- 15 SEE INDIVIDUAL UNIT FLOOR PLANS OR ENLARGED BUILDING PLANS FOR DETAILED INFORMATION ON DIMENSIONS, CONSTRUCTION, DOORS, WINDOWS, AND OTHER ELEMENTS, TYPICAL.
- 16 INTERIOR FINISHES SHALL COMPLY WITH CBC 803.1 FLAME SPREAD PROVISION, SEE INTERIOR DRAWINGS.
- 17 FOR DOOR & WINDOW SCHEDULES SEE SHEET A9.X & A9.X.
- 18 RAMP SLOPES ARE MEASURED FROM CENTERLINE OF RAMP.
- 19 ALL EXIT STAIRS TO COMPLY WITH CBC CHAPTERS 10, 11A AND/OR 11B. EXIT STAIRS AND LANDINGS TO BE 44 INCHES MINIMUM IN WIDTH, STAIR RISERS TO BE MAXIMUM 7 INCHES HIGH, AND TREADS TO BE 11 INCHES MINIMUM DEEP.
- 20 SEE ROOF PLAN GENERAL NOTES FOR DRAINAGE, VENTILATION, AND ROOF ACCESS NOTES.
- 21 ALL RESIDENTIAL UNITS THAT FACE ROADS ARE EQUIPPED WITH EITHER MECHANICAL VENTILATION OR PASSIVE FRESH-AIR INLETS, SEE MECHANICAL DRAWINGS FOR MORE INFORMATION.
- 22 SEE SIGNAGE PLANS AND DETAILS ON A10.X FOR ADDITIONAL INFORMATION REGARDING SIGNS AT UNIT ENTRIES, ELEVATORS, STAIRS, EGRESS COMPONENTS, COMMON AREA DOORS.

FLOOR PLAN LEGEND

2 HR RATED WALL CONSTRUCTION

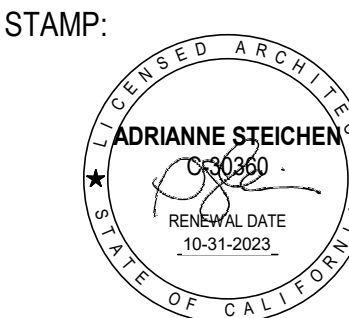

REVISION SCHEDULE	
NO.	ISSUE
1	ISSUE

SITE PERMIT: 04/27/2021

JOB NUMBER:	1941
DRAWN BY:	CA - JB
CHECKED BY:	AS, SP, KSS
ISSUE DATE:	04/27/2022
SCALE:	As Indicated
TITLE:	FLOOR PLAN - LEVEL 3

SHEET:

A2.30

5/2/2022 9:26:00 AM

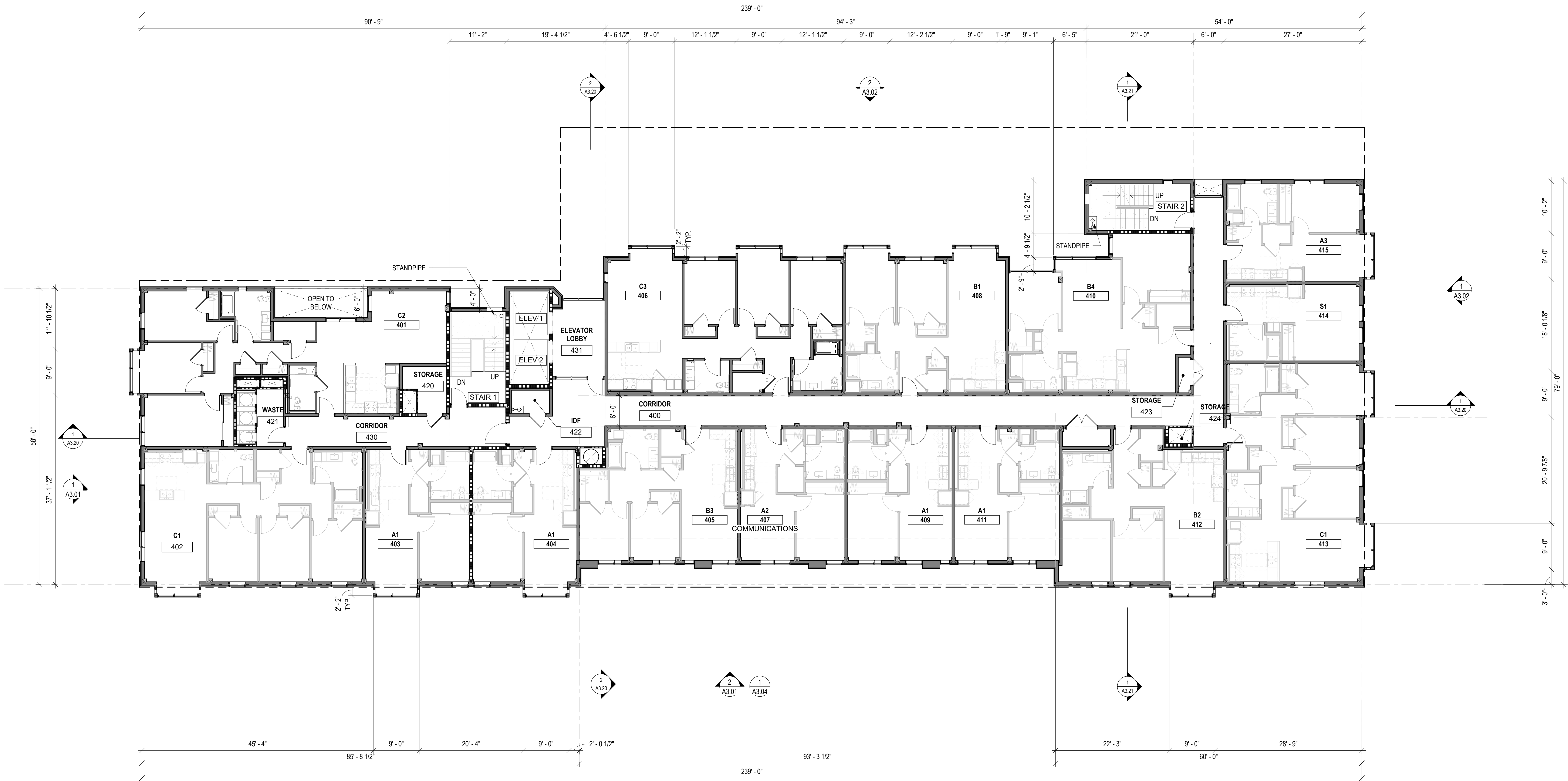

FLOOR PLAN - LEVEL 4 ①
1/8" = 1'-0"

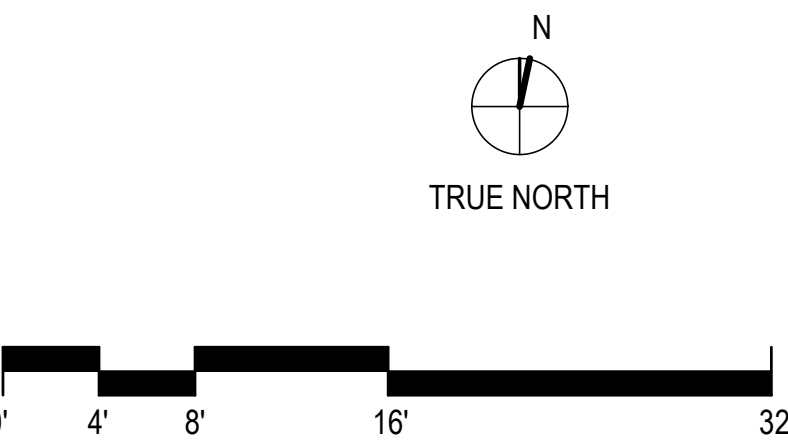

UNIT MATRIX LEVEL 4		
Unit Type	Unit Accessibility	Count
STUDIO: 1	ADAPTABLE	1
1 BEDROOM	ADAPTABLE	5
1 BEDROOM	MOBILITY ACCESSIBLE	1
2 BEDROOM	ADAPTABLE	3
2 BEDROOM	MOBILITY ACCESSIBLE	1
2 BEDROOM: 4		
3 BEDROOM	ADAPTABLE	2
3 BEDROOM	ADAPTABLE, COMMUNICATIONS	1
3 BEDROOM	MOBILITY ACCESSIBLE	1
3 BEDROOM: 4		
UNIT TOTAL: 15		

- FLOOR PLAN GENERAL NOTES**
- 1 SEE SHEET G0.00 FOR SYMBOLS & ABBREVIATIONS
 - 2 THESE PLANS SHOW UNIQUE INFORMATION ONLY. SEE ENLARGED PLANS FOR INFORMATION NOT SHOWN.
 - 3 REFERENCE ACCESSIBILITY CODE SHEETS G9.XX FOR ALL ACCESSIBILITY STANDARDS, REQUIREMENTS AND DIAGRAM.
 - 4 SEE CIVIL PLANS FOR THE BUILDING LOCATION ON SITE AND PRECISE GRADING PLANS.
 - 5 FOR PARKING TABULATION REFER TO SHEET G0.00
 - 6 ALL DIMENSIONS ARE TO FACE OF MASONRY, CONCRETE, STUD, OR CENTERLINE OF COLUMN OR DEMISING WALL (C.L.). U.O.N. ALL "CLEAR" DIMENSIONS ARE TO FACE OF FINISH.
 - 7 ALL CONSTRUCTION TO BE FIRE-RATED PER THE PROJECT DATA ON THE G0.XX SHEETS AND ASSEMBLIES, SHEETS A9.X. UNIT DEMISING WALLS ARE 1-HR RATED, TYPICAL. FOR DETAILED LOCATION OF WALL ASSEMBLY TYPES, SEE ENLARGED PLANS.
 - 8 ALL STAIR, ELEVATOR, TRASH CHUTE, AND VENTILATION SHAFTS TO BE 2-HR FIRE RATED BARRIERS IF CONNECTING MORE THAN 3 STORIES. IF LESS THAN 3 STORIES, THESE MUST BE 1-HR FIRE-RATED CONSTRUCTION.
 - 9 WHERE PROVIDED, CMU PARTITION WALLS TO RECEIVE REINFORCING PER STRUCTURAL DRAWINGS AND TERMINATE AT STRUCTURE ABOVE, U.O.N.
 - 10 ALL INTERIOR EXPOSED CONCRETE WITHIN PUBLIC SPACES IS ARCHITECTURAL FINISH, U.O.N.
 - 11 STUD SIZES TYPICALLY USED THROUGHOUT PROJECT ARE SHOWN - REFER TO STUD SIZE ON WALL ASSEMBLIES, SHEET A9.X, FOR REQUIRED SIZES, GAUGES AND SPACING REQUIRED. COORDINATE BLOCKING AND BRACING REQUIREMENTS FOR ALL WALL-HUNG ITEMS AND VERIFY LOCATIONS PRIOR TO INSTALLATION OF FINISHES.
 - 12 THIS BUILDING TO BE FIRE SPRINKLERED PER APPLICABLE SECTIONS OF CBC CHAPTER 9 AND NFPA 13.
 - 13 CLASS 1 STANDPIPES TO BE INTERCONNECTED.
 - 14 PROVIDE ALL NECESSARY WALL ACCESS PANELS AS REQUIRED FOR MECHANICAL, PLUMBING, FIRE SPRINKLER AND ELECTRICAL SYSTEMS. IN FIRE RATED ASSEMBLIES PROVIDE RATED ACCESS PANELS WITH SELF CLOSING DEVICES.
 - 15 SEE INDIVIDUAL UNIT FLOOR PLANS OR ENLARGED BUILDING PLANS FOR DETAILED INFORMATION ON DIMENSIONS, CONSTRUCTION, DOORS, WINDOWS, AND OTHER ELEMENTS, TYPICAL.
 - 16 INTERIOR FINISHES SHALL COMPLY WITH CBC 803.1 FLAME SPREAD PROVISION, SEE INTERIOR DRAWINGS.
 - 17 FOR DOOR & WINDOW SCHEDULES SEE SHEET A9.X & A9.X.
 - 18 RAMP SLOPES ARE MEASURED FROM CENTERLINE OF RAMP.
 - 19 ALL EXIT STAIRS TO COMPLY WITH CBC CHAPTERS 10, 11A AND/OR 11B. EXIT STAIRS AND LANDINGS TO BE 44 INCHES MINIMUM IN WIDTH, STAIR RISERS TO BE MAXIMUM 7 INCHES HIGH, AND TREADS TO BE 11 INCHES MINIMUM DEEP.
 - 20 SEE ROOF PLAN GENERAL NOTES FOR DRAINAGE, VENTILATION, AND ROOF ACCESS NOTES.
 - 21 ALL RESIDENTIAL UNITS THAT FACE ROADS ARE EQUIPPED WITH EITHER MECHANICAL VENTILATION OR PASSIVE FRESH-AIR INLETS, SEE MECHANICAL DRAWINGS FOR MORE INFORMATION.
 - 22 SEE SIGNAGE PLANS AND DETAILS ON A10.X FOR ADDITIONAL INFORMATION REGARDING SIGNS AT UNIT ENTRIES, ELEVATORS, STAIRS, EGRESS COMPONENTS, COMMON AREA DOORS.

FLOOR PLAN LEGEND

2 HR RATED WALL CONSTRUCTION

PYATOK
1611 TELEGRAPH AVE.
SUITE 200
OAKLAND, CA 94612
T: 510.465.7010 | F: 510.465.8575
www.pyatok.com



TNDC
201 Eddy Street
San Francisco, CA
94102

2550 IRVING ST
2550 Irving Street
San Francisco, CA 94122

STAMP:



REVISION SCHEDULE
NO. | ISSUE | DATE

SITE PERMIT: 04/27/2021

JOB NUMBER: 1941
DRAWN BY: CA - JB
CHECKED BY: AS, SP, KSS
ISSUE DATE: 04/27/2022

SCALE: As Indicated

TITLE:
FLOOR PLAN - LEVEL 4

SHEET:

A2.40

5/2/2022 9:26:02 AM



FLOOR PLAN - LEVEL 5 1
1/8" = 1'-0"

UNIT MATRIX LEVEL 5		
Unit Type	Unit Accessibility	Count
STUDIO: 1	ADAPTABLE	1
1 BEDROOM	ADAPTABLE	4
1 BEDROOM	ADAPTABLE, COMMUNICATIONS	1
1 BEDROOM	MOBILITY ACCESSIBLE	1
1 BEDROOM: 6		
2 BEDROOM	ADAPTABLE	2
2 BEDROOM	ADAPTABLE, COMMUNICATIONS	1
2 BEDROOM	MOBILITY ACCESSIBLE	1
2 BEDROOM: 4		
3 BEDROOM	ADAPTABLE	3
3 BEDROOM	MOBILITY ACCESSIBLE	1
3 BEDROOM: 4		
UNIT TOTAL: 15		

FLOOR PLAN GENERAL NOTES

- 1 SEE SHEET G0.00 FOR SYMBOLS & ABBREVIATIONS
- 2 THESE PLANS SHOW UNIQUE INFORMATION ONLY. SEE ENLARGED PLANS FOR INFORMATION NOT SHOWN.
- 3 REFERENCE ACCESSIBILITY CODE SHEETS G9.XX FOR ALL ACCESSIBILITY STANDARDS, REQUIREMENTS AND DIAGRAMS
- 4 SEE CIVIL PLANS FOR THE BUILDING LOCATION ON SITE AND PRECISE GRADING PLANS.
- 5 FOR PARKING TABULATION REFER TO SHEET G0.00
- 6 ALL DIMENSIONS ARE TO FACE OF MASONRY, CONCRETE, STUD, OR CENTERLINE OF COLUMN OR DEMISING WALL (C.L.). U.O.N. ALL "CLEAR" DIMENSIONS ARE TO FACE OF FINISH.
- 7 ALL CONSTRUCTION TO BE FIRE-RATED PER THE PROJECT DATA ON THE G0.XX SHEETS AND ASSEMBLIES, SHEETS A9.X. UNIT DEMISING WALLS ARE 1-HR RATED, TYPICAL. FOR DETAILED LOCATION OF WALL ASSEMBLY TYPES, SEE ENLARGED PLANS.
- 8 ALL STAIR, ELEVATOR, TRASH CHUTE, AND VENTILATION SHAFTS TO BE 2-HR FIRE RATED BARRIERS IF CONNECTING MORE THAN 3 STORIES. IF LESS THAN 3 STORIES, THESE MUST BE 1-HR FIRE-RATED CONSTRUCTION.
- 9 WHERE PROVIDED, CMU PARTITION WALLS TO RECEIVE REINFORCING PER STRUCTURAL DRAWINGS AND TERMINATE AT STRUCTURE ABOVE, U.O.N.
- 10 ALL INTERIOR EXPOSED CONCRETE WITHIN PUBLIC SPACES IS ARCHITECTURAL FINISH, U.O.N.
- 11 STUD SIZES TYPICALLY USED THROUGHOUT PROJECT ARE SHOWN - REFER TO STUD SIZE ON WALL ASSEMBLIES, SHEET A9.X, FOR REQUIRED SIZES, GAUGES AND SPACING REQUIRED. COORDINATE BLOCKING AND BRACING REQUIREMENTS FOR ALL WALL-HUNG ITEMS AND VERIFY LOCATIONS PRIOR TO INSTALLATION OF FINISHES.
- 12 THIS BUILDING TO BE FIRE SPRINKLERED PER APPLICABLE SECTIONS OF CBC CHAPTER 9 AND NFPA 13.
- 13 CLASS 1 STANDPIPES TO BE INTERCONNECTED.
- 14 PROVIDE ALL NECESSARY WALL ACCESS PANELS AS REQUIRED FOR MECHANICAL, PLUMBING, FIRE SPRINKLER AND ELECTRICAL SYSTEMS. IN FIRE RATED ASSEMBLIES PROVIDE RATED ACCESS PANELS WITH SELF CLOSING DEVICES.
- 15 SEE INDIVIDUAL UNIT FLOOR PLANS OR ENLARGED BUILDING PLANS FOR DETAILED INFORMATION ON DIMENSIONS, CONSTRUCTION, DOORS, WINDOWS, AND OTHER ELEMENTS, TYPICAL.
- 16 INTERIOR FINISHES SHALL COMPLY WITH CBC 803.1 FLAME SPREAD PROVISION, SEE INTERIOR DRAWINGS.
- 17 FOR DOOR & WINDOW SCHEDULES SEE SHEET A9.X & A9.X.
- 18 RAMP SLOPES ARE MEASURED FROM CENTERLINE OF RAMP.
- 19 ALL EXIT STAIRS TO COMPLY WITH CBC CHAPTERS 10, 11A AND/OR 11B. EXIT STAIRS AND LANDINGS TO BE 44 INCHES MINIMUM IN WIDTH, STAIR RISERS TO BE MAXIMUM 7 INCHES HIGH, AND TREADS TO BE 11 INCHES MINIMUM DEEP.
- 20 SEE ROOF PLAN GENERAL NOTES FOR DRAINAGE, VENTILATION, AND ROOF ACCESS NOTES.
- 21 ALL RESIDENTIAL UNITS THAT FACE ROADS ARE EQUIPPED WITH EITHER MECHANICAL VENTILATION OR PASSIVE FRESH-AIR INLETS, SEE MECHANICAL DRAWINGS FOR MORE INFORMATION.
- 22 SEE SIGNAGE PLANS AND DETAILS ON A10.X FOR ADDITIONAL INFORMATION REGARDING SIGNS AT UNIT ENTRIES, ELEVATORS, STAIRS, EGRESS COMPONENTS, COMMON AREA DOORS.

FLOOR PLAN LEGEND

2 HR RATED WALL CONSTRUCTION

PYATOK
1611 TELEGRAPH AVE.
SUITE 200
OAKLAND, CA 94612
T: 510.465.7010 | F: 510.465.8575
www.pyatok.com



TNDc
201 Eddy Street
San Francisco, CA
94102

2550 IRVING ST
2550 Irving Street
San Francisco, CA 94122

STAMP:



REVISION SCHEDULE
NO. | ISSUE | DATE
SITE PERMIT | OCT2021

JOB NUMBER: 1941
DRAWN BY: CA-JB
CHECKED BY: AS, SP, KSS
ISSUE DATE: 04/27/2022
SCALE: As Indicated
TITLE:
FLOOR PLAN - LEVEL 5

SHEET:

A2.50